

**23 MA**  
 兩軸自動求心  
 氣壓夾盤  
 2 ACTUATING AXES  
 SELF-CENTERING  
 SOLID AIR CHUCK  
 FIXTURES



**24 PLVE**  
 後拉式氣壓夾盤  
 PULL BACK  
 POWER CHUCK  
 FIXTURES  
 (PNEUMATIC)



**25 MOT**  
 內藏式中空氣壓  
 二爪夾盤  
 2-JAW HOLLOW  
 POWER CHUCK  
 FIXTURES  
 (PNEUMATIC)



**26 MO**  
 內藏式中空氣壓  
 三爪夾盤  
 3-JAW HOLLOW  
 POWER CHUCK  
 FIXTURES  
 (PNEUMATIC)



**27 MTK**  
 內藏式超精密  
 三爪氣壓夾盤  
 3-JAW SUPER  
 PRECISION AIR  
 CHUCK FIXTURES



**28 MTK-T**  
 內藏式  
 超精密二爪氣壓夾盤  
 2-JAW SUPER  
 PRECISION AIR  
 CHUCK FIXTURES



**29 TK-T**  
 二爪超精密氣壓夾頭  
 2-JAW SUPER  
 PRECISION AIR  
 CHUCKS



**30 TK**  
 三爪超精密氣壓夾頭  
 3-JAW SUPER  
 PRECISION AIR  
 CHUCKS



**31 TB, TBC**  
 氣壓迴轉器  
 AIR FEED TUBE  
 氣壓迴轉器(注水型)  
 AIR FEED TUBE  
 (FOR GRINDER  
 MACHINES)



**31 MTB**  
 氣壓迴轉器  
 AIR FEED TUBE



**32 ADP, FR**  
 連結盤  
 MOUNTING PLATES  
 超精密生爪成型盤  
 FORMING RINGS  
 (FOR SOFT JAWS OF  
 SUPER PRECISION  
 AIR CHUCKS)



**32 J**  
 超精密夾頭生爪  
 SOFT JAWS FOR  
 SUPER PRECISION  
 CHUCKS



**33 MR**  
 三爪氣壓夾頭  
 3-JAW AIR CHUCK



**34 MR-S**  
 雙氣缸三爪氣壓夾頭  
 3-JAW AIR CHUCK  
 BUILT-IN 2  
 CYLINDERS



**35 RT-T**  
 二爪迴轉式氣壓夾盤  
 2-JAW ROTARY AIR  
 CHUCK FIXTURES



**35 RT**  
 三爪迴轉式氣壓夾盤  
 3-JAW ROTARY AIR  
 CHUCK FIXTURES



## 迴轉式氣壓夾盤

輕切削加工適用 Suitable for light cutting

迴轉式氣壓夾盤適用於分度盤，具可隨分度盤主軸旋轉功能，動力夾持加工物作角度分割或旋轉切削。

新產品  
**NEW**

專利產品  
Patent Protected

- 氣缸防銹處理：**在潮溼及工作環境較差的情況，氣缸內部經防銹處理，不會生銹或卡死。
- 防塵裝置：**工作中的鐵屑及切削液不易進入夾盤內部的缸室，確保夾盤的使用壽命及精度保持。
- 前置式氣缸：**氣缸與夾盤直結設計，確保夾持的穩定性，更方便於組裝及操作。



It's Ideal for dividing or cutting work pieces by mounting the chuck on indexing table or rotary table. The distinctive feature is that the chuck rotates with the spindle of indexing table or rotary table.

### 尺寸圖 > Dimensions

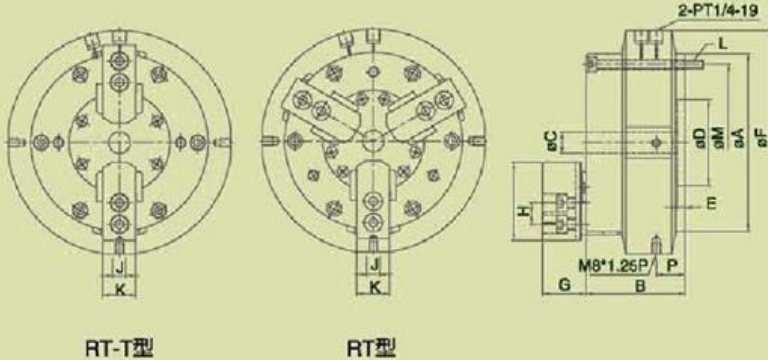

- Rustproof treated cylinder:**  
The cylinder won't get rusty and seized even in wet or high moisture working environment.
- Dust and water proof cover:**  
Prevent metal chips or coolant from entering inside of chuck cylinder to maintain its accuracy and lead to longer service life.
- Integral pneumatic cylinder:**  
Connect chuck and built-in cylinder to each other directly; thus enables operation stability. Moreover, it is more convenient for installation and operation since the use of draw tube and draw bar are no longer necessary.

### 使用範例 > Operation Example



### 規格表 > Specifications

型式/規格 MODEL /SPEC.	A	B	C	D	E	F	G	H	I	J	K	L
RT-05	140	85	16	60	6	180	33	62	14	10	25	6-M8x1.25P
RT-06	170	93	20	80	7	210	40	73	20	12	31	6-M8x1.25P
RT-08	215	112	30	110	8	250	42	95	25	14	35	6-M10x1.5P
RT-10	255	120	43	140	8	290	46	110	30	16	40	6-M10x1.5P
RT-05T	140	85	16	60	6	180	33	62	14	10	25	6-M8x1.25P
RT-06T	170	93	20	80	7	210	40	73	20	12	31	6-M8x1.25P

型式/規格 MODEL /SPEC.	M	P	通孔直徑 Thru-Hole (Diameter) (mm)	活塞面積 Piston Area (cm <sup>2</sup> )	柱塞行程 Plunger Stroke (mm)	爪行程(直徑) Jaw Stroke (Diameter) mm
RT-05	ø118	27	16	74	10	4.6
RT-06	ø147	27	20	120	13	5.5
RT-08	ø185	28	30	190	16	6.8
RT-10	ø220	30.5	43	280	19	8.0
RT-05T	ø118	27	16	74	10	4.6
RT-06T	ø147	27	20	120	13	5.5

型式/規格 MODEL /SPEC.	最高轉速 Max. Speed r.p.m.(min <sup>-1</sup> )	最大設定壓力 Max. Pressure kgf/cm <sup>2</sup> (Mpa)	氣壓夾持力 Gripping Force At Air Pressure 7kgf/cm <sup>2</sup> (0.7Mpa) kgf (KN)	夾持範圍 Gripping Range	淨重 Weight (kg)
RT-05	51	7 (0.7)	1340 (13.1)	ø4-ø136	9.3
RT-06	41	7 (0.7)	2330 (22.8)	ø25-ø166	15.5
RT-08	33	7 (0.7)	3730 (36.5)	ø33-ø215	28.5
RT-10	26	7 (0.7)	5480 (53.7)	ø43-ø255	42.3
RT-05T	51	7 (0.7)	1340 (13.1)	ø4-ø136	9.0
RT-06T	41	7 (0.7)	2330 (22.8)	ø25-ø166	15.0

# TK-T 2-JAW SUPER PRECISION AIR CHUCK

## 二爪超精密氣壓夾頭

新產品  
**NEW**

專利產品  
Patent Protected

1. 預設治具孔及預留自動潤滑管道：爪殼預設治具孔，有額外固定需要時不須再追加加工；且預留自動潤滑管道，可與自動潤滑裝置連結。
2. 內藏式汽缸：汽缸與夾盤直結設計，確保作動及夾持的穩定性。
3. 生爪精密定位：設有定位銷使生爪在重複拆裝時仍保持良好的定位精度。
4. 超高精度夾持提高工作效率：夾持工件的同軸度及重覆夾持精度可達 $\mu$ 級，簡化操作，實現高效率的精密加工。



### 尺寸圖 > Dimensions

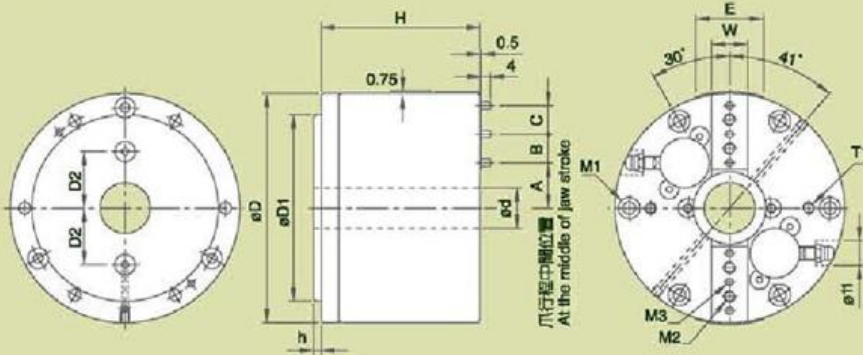

#### 1. Pre-machined tapped holes and lubrication path:

There are tapped holes for fixing jigs, thus, additional screw machining is not necessary, and pre-machined lubrication path can connect to auto-lubrication unit to lubricate the chuck automatically.

#### 2. Built-in Cylinder:

Connect cylinder directly to the chuck for stable gripping.

#### 3. Precise soft jaw positioning:

It's easy to remount soft jaw to the correct position with dowel pins on it.

#### 4. High gripping precision brings better quality and efficiency.

Good coaxiality and repeatability of gripping are able to achieve the accuracy of " $\mu$  degree machining processes can be simplified or shortened to make high precision machining with high efficiency come true.

### 本產品精密度可達 $\mu$ 級

This product reaches the repeatability of " $\mu$  degree"

### 應用範例 > Operation Example



### 規格表 > Specifications

單位/UNIT:mm

型式/規格 MODEL /SPEC.	A	B	C	D	E	D1	d (H7)	D2	H	h
TK-04T	20.75	12.7	12.7	101.6	30	82.55	18	25	70.3	3.2
TK-06T	39.75	12.7	12.7	152.4	40	124.97	26	34.5	70.3	3.2
TK-08T	65.75	25.4	--	203.2	45	167.64	50	50	99.5	7.0

型式/規格 MODEL /SPEC.	M1	M2	M3	W	T1
TK-04T	6-M5x0.8P(PCD $\phi$ 88.9)	4-M5x0.8P	6- $\phi$ 3.18	16	2-M5x0.8P(PCD $\phi$ 70)
TK-06T	6-M6x1P(PCD $\phi$ 135.89)	8-M5x0.8P	6- $\phi$ 3.18	22	2-M6x1P(PCD $\phi$ 110)
TK-08T	6-M10x1.5P(PCD $\phi$ 182.88)	4-M10x1.5P	4- $\phi$ 6.36	25	2-M8x1.25P(PCD $\phi$ 150)

型式/規格 MODEL /SPEC.	爪行程(值) Jaw Stroke [Diameter](mm)	空壓夾持力 Gripping Force At Air Pressure 7 kgf/cm <sup>2</sup> (0.7Mpa) kgf (KN)	最高迴轉速 Max.Speed r.p.m (min <sup>-1</sup> )	淨重 Weight (kg)
TK-04T	3	310 (3.1)	3500	4.2
TK-06T	3	790 (7.8)	3500	9.5
TK-08T	3	1450 (14.3)	3000	25.1

# MR 3-JAW AIR CHUCK

## 三爪氣壓夾頭

新產品  
**NEW**

專利產品  
Patent Protected



### 尺寸圖 > Dimensions

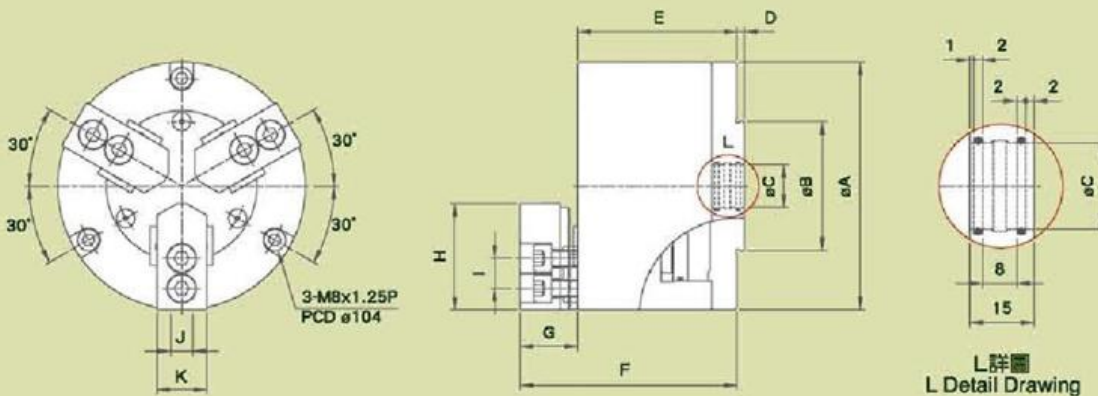

L 詳圖  
L Detail Drawing

### 分度盤使用範例 > Operation Example for rotary table

### CNC車床使用範例 > Operation Example for CNC Lathe



### 規格表 > Specifications

單位/UNIT:mm

型式/規格 MODEL /SPEC.	A	B	C	D	E	F	G	H	I	J	K	活塞面積 Piston Area (cm <sup>2</sup> )
MR-04	117	60	20	3.5	74	100.7	26.7	49.5	14	10	23	57
型式/規格 MODEL /SPEC.	柱塞行程 Plunger Stroke (mm)		爪行程直徑 Jaw Stroke (Diameter) mm		空壓夾持力 At Air Pressure 7 kgf/cm <sup>2</sup> (0.7Mpa) kgf		Gripping Force (KN)		最高迴轉速 Max.Speed r.p.m (min <sup>-1</sup> )	夾持範圍 Gripping Range	淨重 Weight (kg)	
MR-04	9		3.8		1100		(10.8)		3000	φ10~φ117	5.7	

## 迴轉式氣壓夾盤

輕切削加工適用 Suitable for light cutting

迴轉式氣壓夾盤適用於分度盤，具可隨分度盤主軸旋轉功能，動力夾持加工物作角度分割或旋轉切削。

新產品  
**NEW**

專利產品  
Patent Protected

- 氣缸防銹處理：**在潮溼及工作環境較差的情況，氣缸內部經防銹處理，不會生銹或卡死。
- 防塵裝置：**工作中的鐵屑及切削液不易進入夾盤內部的缸室，確保夾盤的使用壽命及精度保持。
- 前置式氣缸：**氣缸與夾盤直結設計，確保夾持的穩定性，更方便於組裝及操作。



It's Ideal for dividing or cutting work pieces by mounting the chuck on indexing table or rotary table. The distinctive feature is that the chuck rotates with the spindle of indexing table or rotary table.

### 尺寸圖 > Dimensions

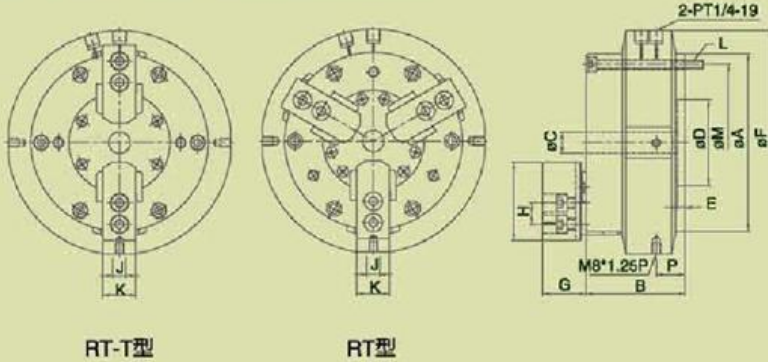

- Rustproof treated cylinder:**  
The cylinder won't get rusty and seized even in wet or high moisture working environment.
- Dust and water proof cover:**  
Prevent metal chips or coolant from entering inside of chuck cylinder to maintain its accuracy and lead to longer service life.
- Integral pneumatic cylinder:**  
Connect chuck and built-in cylinder to each other directly; thus enables operation stability. Moreover, it is more convenient for installation and operation since the use of draw tube and draw bar are no longer necessary.

### 使用範例 > Operation Example



### 規格表 > Specifications

型式/規格 MODEL /SPEC.	A	B	C	D	E	F	G	H	I	J	K	L
RT-05	140	85	16	60	6	180	33	62	14	10	25	6-M8x1.25P
RT-06	170	93	20	80	7	210	40	73	20	12	31	6-M8x1.25P
RT-08	215	112	30	110	8	250	42	95	25	14	35	6-M10x1.5P
RT-10	255	120	43	140	8	290	46	110	30	16	40	6-M10x1.5P
RT-05T	140	85	16	60	6	180	33	62	14	10	25	6-M8x1.25P
RT-06T	170	93	20	80	7	210	40	73	20	12	31	6-M8x1.25P

型式/規格 MODEL /SPEC.	M	P	通孔直徑 Thru-Hole (Diameter) (mm)	活塞面積 Piston Area (cm <sup>2</sup> )	柱塞行程 Plunger Stroke (mm)	爪行程(直徑) Jaw Stroke (Diameter) mm
RT-05	ø118	27	16	74	10	4.6
RT-06	ø147	27	20	120	13	5.5
RT-08	ø185	28	30	190	16	6.8
RT-10	ø220	30.5	43	280	19	8.0
RT-05T	ø118	27	16	74	10	4.6
RT-06T	ø147	27	20	120	13	5.5

型式/規格 MODEL /SPEC.	最高轉速 Max. Speed r.p.m.(min <sup>-1</sup> )	最大設定壓力 Max. Pressure kgf/cm <sup>2</sup> (Mpa)	氣壓夾持力 Gripping Force At Air Pressure 7kgf/cm <sup>2</sup> (0.7Mpa) kgf (KN)	夾持範圍 Gripping Range	淨重 Weight (kg)
RT-05	51	7 (0.7)	1340 (13.1)	ø4-ø136	9.3
RT-06	41	7 (0.7)	2330 (22.8)	ø25-ø166	15.5
RT-08	33	7 (0.7)	3730 (36.5)	ø33-ø215	28.5
RT-10	26	7 (0.7)	5480 (53.7)	ø43-ø255	42.3
RT-05T	51	7 (0.7)	1340 (13.1)	ø4-ø136	9.0
RT-06T	41	7 (0.7)	2330 (22.8)	ø25-ø166	15.0

## 三爪超精密氣壓夾頭

新產品  
**NEW**

專利產品  
Patent Protected

1. 預設治具孔及預留自動潤滑管道：爪殼預設治具孔，有額外固定需要時不須再追加加工；且預留自動潤滑管道，可與自動潤滑裝置連結。
2. 內藏式汽缸：汽缸與夾盤直結設計，確保作動及夾持的穩定性。
3. 生爪精密定位：設有定位銷使生爪在重複拆裝時仍保持良好的定位精度。
4. 超高精度夾持提高工作效率：夾持工件的同軸度及重複夾持精度可達 $\mu$ 級，簡化操作，實現高效率的精密加工。



### 尺寸圖 > Dimensions

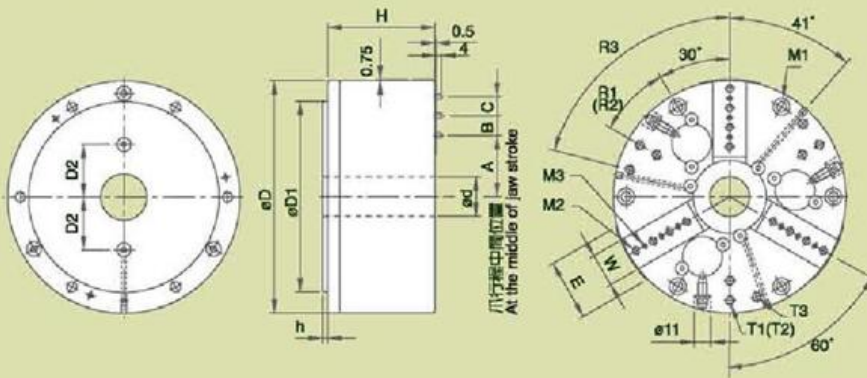

1. **Pre-machined tapped holes and lubrication path:**  
There are tapped holes for fixing jigs, thus, additional screw machining is not necessary, and pre-machined lubrication path can connect to auto-lubrication unit to lubricate the chuck automatically.
2. **Built-in Cylinder:**  
Connect cylinder directly to the chuck for stable gripping.
3. **Precise soft jaw positioning:**  
It's easy to remount soft jaw to the correct position with dowel pins on it.
4. **High gripping precision brings better quality and efficiency.**  
Good coaxiality and repeatability of gripping are able to achieve the accuracy of " $\mu$  degree machining processes can be simplified or shortened to make high precision machining with high efficiency come true.

本產品精密度可達 $\mu$ 級  
This product reaches the repeatability of " $\mu$  degree"

### 應用範例 > Operation Example



### 規格表 > Specifications

單位/UNIT:mm

型式/規格 MODEL / SPEC.	A	B	C	D	E	D1	d (H7)	D2	H	h	W	M1
TK-04	20.75	12.7	12.7	101.6	30	82.55	18	25	70.3	3.2	16	6-M5x0.8P(PCD $\phi$ 88.9)
TK-06	39.75	12.7	12.7	152.4	40	124.97	26	34.5	70.3	3.2	22	6-M6x1P(PCD $\phi$ 135.89)
TK-08	65.75	25.4	--	203.2	45	167.64	50	50	99.5	7.0	25	6-M10x1.5P(PCD $\phi$ 182.88)

型式/規格 MODEL / SPEC.	M2	M3	T1	T2	T3	R1
TK-04	6-M5x0.8P	9- $\phi$ 3.18	3-M5x0.8P(PCD $\phi$ 88.9)	--	--	30°
TK-06	12-M5x0.8P	9- $\phi$ 3.18	3-M6x1P(PCD $\phi$ 135.89)	3-M6x1P(PCD $\phi$ 110)	3-M6x1P(PCD $\phi$ 135.89)	30°
TK-08	6-M10x1.5P	6- $\phi$ 6.36	3-M8x1.25P(PCD $\phi$ 182.88)	3-M8x1.25P(PCD $\phi$ 150)	3-M8x1.25P(PCD $\phi$ 100)	30°

型式/規格 MODEL / SPEC.	R2	R3	爪行程 (直徑) Jaw Stroke [Diameter] (mm)	空壓夾持力 At Air Pressure 7kgf/cm <sup>2</sup> (0.7Mpa) kgf	Gripping Force (KN)	最高迴轉速 Max.Speed r.p.m(min <sup>-1</sup> )	淨重 Weight (kg)
TK-04	--	--	3	310	(3.1)	4500	4.4
TK-06	30°	75°	3	790	(7.8)	4500	9.8
TK-08	30°	30°	3	1450	(14.3)	4000	26.3



## 內藏式中空(氣) 油壓三爪夾盤

L:加長行程



內藏式中空油壓夾盤適用於工作台面的銼、銑加工而設計。

- 氣缸防銹處理:** 在潮溼及工作環境較差的情況, 氣缸內部經防銹處理, 不會生銹或卡死。
- 防塵裝置:** 在工作台上的銼銑工作、切屑及冷卻液不易進入夾盤內部, 確保夾盤的使用壽命及精度。
- 內藏式油缸特性:** 把油缸直接裝置於夾頭內部, 更能確保連結的穩定性、提升夾持力, 適用於重切削及夾持精度的保持, 倍增機械效益。

### 尺寸圖 > Dimensions

專利產品  
Patent Protected

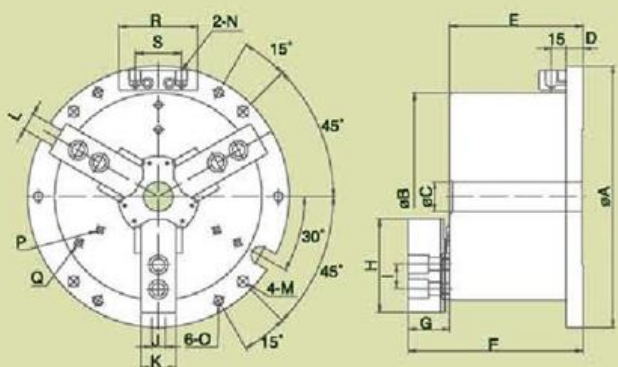

With built-in type cylinder, it is ideal for machining application on working table.

- Rust-proof for Pneumatic Cylinder:**  
Inside wall of cylinder being rustproof treated; cylinder can work under wet or high moisture circumstances without rusty or seized trouble.
- Dusts-proof and Waterproof:**  
Dust-proof and Waterproof structure prevents work-chips and coolant water from entering into inside of chuck cylinder to maintain its accuracy and lead to longer service life.
- Benefit of Built-in Cylinder:**  
The cylinder is connected to chuck itself directly for obtaining better stability, less space, and higher machining efficiency.

### 應用範例 > Operation Example

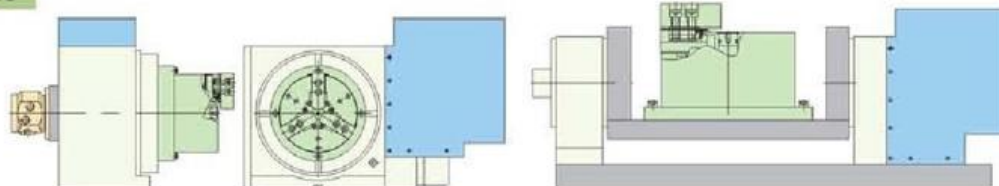

### 規格表 > Specifications

單位/UNIT:mm

型式/規格 MODEL /SPEC.	A	B	C	D	E	F	G	H	I	J	K	L	M	N	O	P	R	S
MO-04	157	115	--	15	77.5	104	26	49.5	14	10	23	13	ø9 (PCD ø135)	PT1/8	M8x1.25P	3-M8x1.25P(PCDø90)	64	47
MO-05	185	135	--	15	95	128	33	62	14	10	25	13	ø9 (PCD ø165)	PT1/4	M8x1.25P	3-M8x1.25P(PCDø100)	80	47
MO-06	224	169	25	16	118	158	40	73	20	12	31	18	ø11 (PCD ø202)	PT1/4	M10x1.5P	3-M8x1.25P(PCDø134)	80	47
MO-08	265	210	30	20	138	180	42	95	25	14	35	18	ø11 (PCD ø243)	PT1/4	M10x1.5P	3-M10x1.5P(PCDø136)	80	47
MO-10	315	254	52	23	150	196	46	110	30	16	40	18	ø13 (PCD ø285)	PT1/4	M12x1.75P	3-M12x1.75P(PCDø170)	80	47
MO-12	375	304	80	23	165	219	54	129	30	21	50	18	ø17 (PCD ø340)	PT3/8	M16x2P	3-M12x1.75P(PCDø200)	80	55
ML-08	265	210	30	20	138	180	42	95	25	14	35	18	ø11 (PCD ø243)	PT1/4	M10x1.5P	3-M10x1.5P(PCDø136)	80	47

型式/規格 MODEL /SPEC.	Q	活塞面積 Piston Area (cm <sup>2</sup> )	柱塞行程 Plunger Stroke (mm)	爪行程 (直徑) Jaw Stroke (Diameter) (mm)	最大靜夾持力 Max.Gripping Force kgf (KN)	最大設定 油壓壓力 Max. Hydr. Pressure kgf/cm <sup>2</sup> (Mpa)	空壓夾持力 Gripping Force At Air Pressure 7 kgf/cm <sup>2</sup> (0.7Mpa) kgf (KN)	淨重 Weight (kg)	夾持範圍 Gripping Range
MO-04	--	57	9	3.8	2400 (23.5)	15 (1.5)	1100 (10.8)	7.05	ø9~ø115
MO-05	--	74	10	5.4	3285 (32.2)	20 (2.0)	1300 (12.7)	11.2	ø12~ø135
MO-06	--	97	12	5.5	5040 (49.4)	20 (2.0)	2000 (19.6)	21.0	ø15~ø169
MO-08	3-M10x1.5P(PCDø186)	156	16	7.4	8100 (79.4)	20 (2.0)	3300 (32.3)	36.8	ø20~ø210
MO-10	3-M12x1.75P(PCDø230)	235	19	8.8	12210 (119.7)	20 (2.0)	4800 (47.0)	56.4	ø33~ø254
MO-12	3-M12x1.75P(PCDø260)	292	23	10.6	14500 (142.1)	20 (2.0)	5100 (50.0)	88.5	ø40~ø304
ML-08	3-M10x1.5P(PCDø186)	156	16.5	12	5202 (51)	20 (2.0)	1836 (18)	37.6	ø20~ø210



### 內藏式超精密二爪氣壓夾盤

新產品  
**NEW**

專利產品  
Patent Protected

1. 預設治具孔及預留自動潤滑管道：爪殼預設治具孔，有額外固定需要時不須再追加加工；且預留自動潤滑管道，可與自動潤滑裝置連結。
2. 內藏式汽缸：汽缸與夾盤直結設計，確保作動及夾持的穩定性。
3. 生爪精密定位：設有定位銷使生爪在重複拆裝時仍保持良好的定位精度。
4. 超高精度夾持提高工作效率：夾持工件的同軸度及重複夾持精度可達 $\mu$ 級，簡化操作，實現高效率的精密加工。

#### 尺寸圖 > Dimensions

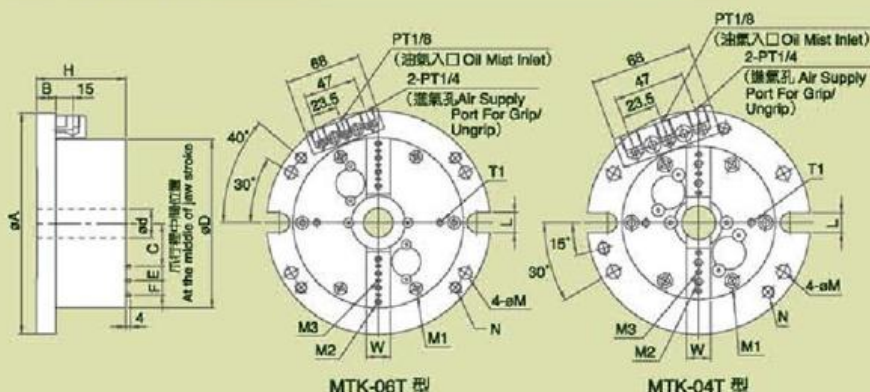

1. **Pre-machined tapped holes and lubrication path:**  
There are tapped holes for fixing jigs, thus, additional screw machining is not necessary, and pre-machined lubrication path can connect to auto-lubrication unit to lubricate the chuck automatically.
2. **Built-in Cylinder:**  
Connect cylinder directly to the chuck for stable gripping.
3. **Precise soft jaw positioning:**  
It's easy to remount soft jaw to the correct position with dowel pins on it.
4. **High gripping precision brings better quality and efficiency.**  
Good coaxiality and repeatability of gripping are able to achieve the accuracy of  $\mu$  degree machining processes can be simplified or shortened to make high precision machining with high efficiency come true.

### 本產品精密度可達 $\mu$ 級

This product reaches the repeatability of " $\mu$  degree"

#### 應用範例 > Operation Example

氣壓切換閥連接方式 / 特殊附件  
Examples of Attaching Pneumatic Manual Switch / Optional Accessories



外接氣壓手動切換閥  
Split type hand control valve

單位/UNIT:mm

#### 規格表 > Specifications

型式/規格 MODEL / SPEC.	A	B	C	D	d (H7)	E	F	H	W	L
MTK-04T	148	17	20.75	101.6	18	12.7	12.7	80	16	13
MTK-06T	200	18	39.75	152.4	26	12.7	12.7	81	22	18
型式/規格 MODEL / SPEC.	M		M1		M2		M3		N	
MTK-04T	$\varnothing 9$ (PCD $\varnothing 130$ )		6-M5x0.8P(PCD $\varnothing 88.9$ )		4-M5x0.8P		6- $\varnothing 3.18$		3-M8x1.25P	
MTK-06T	$\varnothing 11$ (PCD $\varnothing 180$ )		6-M6x1P(PCD $\varnothing 135.89$ )		8-M5x0.8P		6- $\varnothing 3.18$		4-M10x1.5P	
型式/規格 MODEL / SPEC.	T1		爪行程(直徑) Jaw Stroke (Diameter) (mm)		空壓夾持力 Gripping Force At Air Pressure 7 kgf/cm <sup>2</sup> (0.7Mpa) kgf (kN)		淨重 Weight (kg)			
MTK-04T	2-M5x0.8P(PCD $\varnothing 70$ )		3		310 (3.1)		6			
MTK-06T	2-M6x1P(PCD $\varnothing 110$ )		3		790 (7.8)		12.6			

### 內藏式超精密三爪氣壓夾盤

新產品 **NEW** 專利產品 Patent Protected

1. 預設治具孔及預留自動潤滑管道：爪殼預設治具孔，有額外固定需要時不須再追加加工；且預留自動潤滑管道，可與自動潤滑裝置連結。
2. 內藏式汽缸：汽缸與夾盤直結設計，確保作動及夾持的穩定性。
3. 生爪精密定位：設有定位銷使生爪在重複拆裝時仍保持良好的定位精度。
4. 超高精度夾持提高工作效率：夾持工件的同軸度及重複夾持精度可達 $\mu$ 級，簡化操作，實現高效率的精密加工。



#### 尺寸圖 > Dimensions

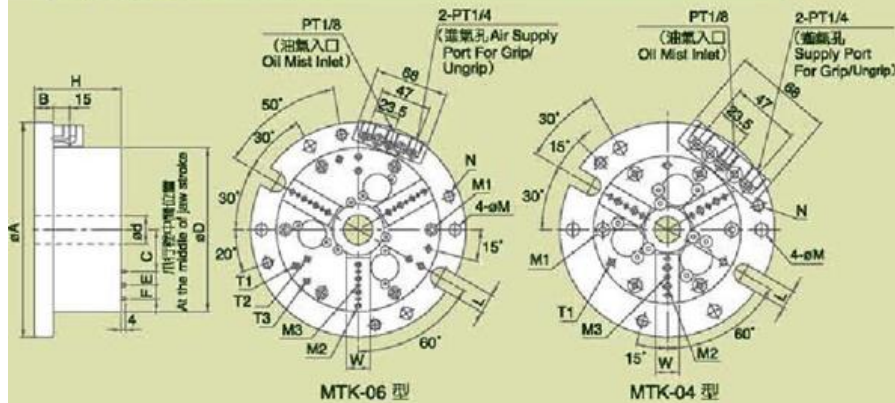

1. Pre-machined tapped holes and lubrication path: There are tapped holes for fixing jigs, thus, additional screw machining is not necessary, and pre-machined lubrication path can connect to auto-lubrication unit to lubricate the chuck automatically.
2. Built-in Cylinder: Connect cylinder directly to the chuck for stable gripping.
3. Precise soft jaw positioning: It's easy to remount soft jaw to the correct position with dowel pins on it.
4. High gripping precision brings better quality and efficiency. Good coaxiality and repeatability of gripping are able to achieve the accuracy of  $\mu$  degree machining processes can be simplified or shortened to make high precision machining with high efficiency come true.

本產品精密度可達 $\mu$ 級  
This product reaches the repeatability of " $\mu$  degree"

#### 應用範例 > Operation Example

氣壓切換閥連接方式 / 特殊附件  
Examples of Attaching Pneumatic Manual Switch / Optional Accessories



單位/UNIT:mm

#### 規格表 > Specifications

型式/規格 MODEL / SPEC.	A	B	C	D	d (H7)	E	F	H	W	L	M
MTK-04	148	17	20.75	101.6	18	12.7	12.7	80	16	13	$\phi 9$ (PCD $\phi 130$ )
MTK-06	200	18	39.75	152.4	26	12.7	12.7	81	22	18	$\phi 11$ (PCD $\phi 180$ )
型式/規格 MODEL / SPEC.	M1			M2		M3		N		T1	
MTK-04	6-M5x0.8P(PCD $\phi 88.9$ )			6-M5x0.8P		9- $\phi 3.18$		3-M8x1.25P		3-M5x0.8P(PCD $\phi 88.9$ )	
MTK-06	6-M6x1P(PCD $\phi 135.89$ )			12-M5x0.8P		9- $\phi 3.18$		4-M10x1.5P		3-M6x1P(PCD $\phi 135.89$ )	
型式/規格 MODEL / SPEC.	T2		T3		爪行程(直徑) Jaw Stroke (Diameter) (mm)		空壓夾持力 Gripping Force At Air Pressure 7 kgf/cm <sup>2</sup> (0.7Mpa) kgf (KN)		淨重 Weight (kg)		
MTK-04	--		--		3		310 (3.1)		6.2		
MTK-06	3-M6x1P(PCD $\phi 110$ )		3-M6x1P(PCD $\phi 135.89$ )		3		790 (7.8)		13		

# MA 2ACTUATING AXES SELF-CENTERING SOLID AIR CHUCK FIXTURES

## 兩軸自動求心氣壓夾盤

兩軸自動求心氣壓夾盤專供中心機及各式工作台面的加工而設計，在X,Y兩軸間同時夾持任何異形工件具快速自定工件中心之功能。具3大特色：

- 1.氣缸防銹處理：**在潮溼及工作環境較差的情況，氣缸內部經防銹處理，不會生銹或卡死。
- 2.防塵裝置：**在工作台上的銼銑工作、切屑及冷卻液不易進入夾盤內部，確保夾盤的使用壽命及精度。
- 3.多邊夾持、自定中心：**有別於虎鉗的單一軸向夾持，兩軸自動求心氣壓夾盤分別在X,Y兩軸向分割成兩組夾持動作，且同時自定工件中心，能快速準確的固定工件，在任一軸向銼削均能達到穩固的效果。



### 尺寸圖 > Dimensions

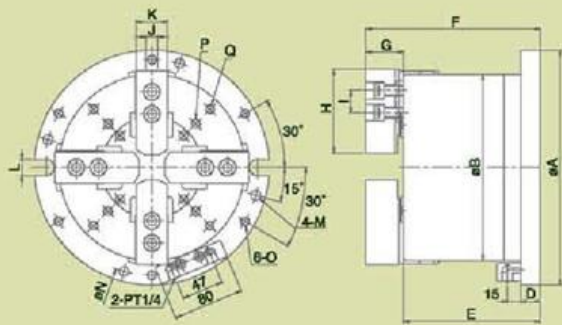

新產品  
**NEW**  
專利產品  
Patent Protected

2 actuating axes self-centering solid air chuck fixtures is great for machining center. Two pairs of jaws clamp one after another to assure a workpiece to be locked completely.

- 1.Rust-proof for Pneumatic Cylinder:**  
Inside wall of cylinder being rustproof treated; cylinder can work under wet or high moisture circumstances without rusty or seized trouble.
- 2.Dusts-proof and Waterproof:**  
Dust-proof and Waterproof structure prevents work-chips and coolant water from entering into inside of chuck cylinder to maintain its accuracy and lead to longer service life.
- 3.4-jaw Clamping and Self-centering:**  
4-jaw clamping are steadier for machining. Two pairs of jaws are moved independently to assure complete lock and self-centering.

### 應用實例 > Operation Example

快速、準確、自動化  
Speed, Accurate, Automatic  
兩段分割夾持，自定中心  
4-jaws clamping and self-center

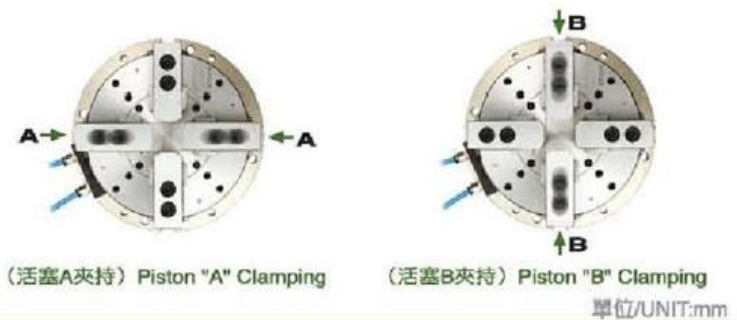

### 規格表 > Specifications

型式/規格 MODEL /SPEC.	A	B	D	E	F	G	H	I	J	K	L	M	N
MA-06	224	175	20	130	170	40	73	20	12	31	18	ø11	ø202
MA-08	265	210	22	154	196	42	95	25	14	35	18	ø11	ø243
MA-10	315	250	25	176	222	46	110	30	16	40	18	ø13	ø285

型式/規格 MODEL /SPEC.	O		P		Q		A 活塞面積 Piston Area (cm <sup>2</sup> )	
	推力側 Push Side	拉力側 Pull Side	推力側 Push Side	拉力側 Pull Side	推力側 Push Side	拉力側 Pull Side	推力側 Push Side	拉力側 Pull Side
MA-06	M10x1.5P(PCD ø202)		4-M8x1.25P(PCD ø124)		4-M8x1.25P(PCD ø156)		127	108
MA-08	M10x1.5P(PCD ø243)		4-M10x1.5P(PCD ø140)		4-M10x1.5P(PCD ø186)		184	157
MA-10	M12x1.75P(PCD ø285)		4-M10x1.5P(PCD ø176)		4-M10x1.5P(PCD ø224)		270	239

型式/規格 MODEL /SPEC.	B 活塞面積 Piston Area (cm <sup>2</sup> )		柱塞行程 Plunger Stroke (mm)	爪行程 (直徑) Jaw Stroke (Diameter) (mm)	空壓夾持力 Gripping Force At Air Pressure 7kgf/cm <sup>2</sup> (0.7Mpa)		淨重 Weight (kg)	夾持範圍 Gripping Range
	推力側 Push Side	拉力側 Pull Side			kgf	(KN)		
MA-06	122	117	12	5.5	4500	(44)	24.8	ø25~ø175
MA-08	176	169	16	7.4	6400	(63)	41.3	ø30~ø210
MA-10	254	241	19	8.8	9500	(93)	65.6	ø35~ø250

## 後拉式(氣)油壓夾盤

後拉式(氣)油壓夾盤在工作台面的鉗、銑加工時，夾持工件穩固不會上浮，適用重切削或鑄件及鍛件的加工。

- 氣缸防鏽處理：**在潮濕及工作環境較差的情況，氣缸內部經防鏽處理，不會生鏽或卡死。
- 防塵裝置：**在工作台上的鉗銑加工、切屑及冷卻液不會進入夾盤內部，確保夾盤的使用壽命及精度。
- 重力夾持設計：**搭配油壓系統作重力夾持工件，結構設計穩固不會變形。



### 尺寸圖 > Dimensions

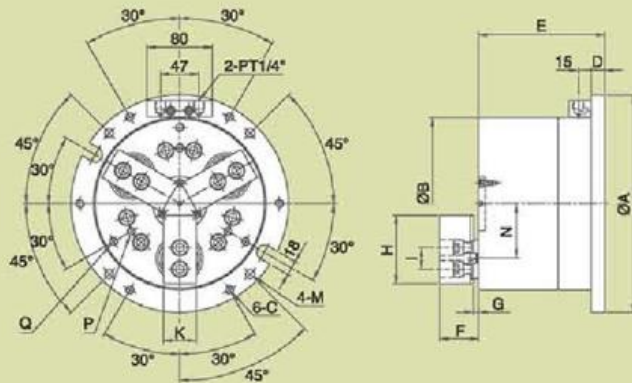

Pull Back Power Chuck Fixture is ideal for machining application on working table, workpiece can be clamped firmly not lift up; it is suitable for heavy cutting as well as the casting and forging machining.

- Rust-proof for Pneumatic Cylinder:**  
Inside wall of cylinder being rustproof treated; cylinder can work under wet or high moisture circumstances without rusty or seized trouble.
- Dusts-proof and Waterproof:**  
Dust-proof and Waterproof structure prevents work-chips and coolant water from entering into inside of chuck cylinder to maintain its accuracy and lead to longer service life.
- Heavy Duty Clamping Design:**  
Collocating hydraulic system to do heavy duty clamping, the chuck structure is steady and won't deform.

### 應用實例 > Operation Example

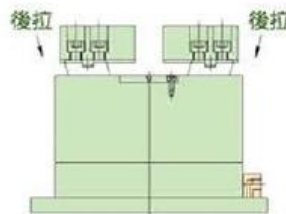

單位/UNIT:mm

### 規格表 > Specifications

型式/規格 MODEL / SPEC.	A	B	C	D	E	F Max.	F min.	G Max.	G min.	H	I	K	M
PLVE-06	224	169	M10x1.5P(PCDø202)	17	140	45.65	35.65	14.65	4.65	70	--	35	ø11(PCD 202)
PLVE-08	265	210	M10x1.5P(PCDø243)	17	154	57.15	47.15	16.15	6.15	84	26	40	ø11(PCD 243)
PLVE-10	315	254	M12x1.75P(PCDø285)	20	185	67.6	51.6	21.6	5.6	100	32	50	ø13(PCD 285)

型式/規格 MODEL / SPEC.	N Max.	N min.	P	Q	活塞面積 Piston Area (cm <sup>2</sup> )	柱塞行程 Plunger Stroke (mm)	爪行程〔直徑〕 Jaw Stroke [Diameter] (mm)
PLVE-06	56.69	54.01	3-M6x1P(PCDø80)	3-M6x1P(PCDø120)	91	10	5.3
PLVE-08	69.56	66.88	3-M10x1.5P(PCDø136)	3-M10x1.5P(PCDø186)	160	10	5.3
PLVE-10	87.44	81.61	3-M12x1.75P(PCDø170)	3-M12x1.75P(PCDø230)	215	16	11.6

型式/規格 MODEL / SPEC.	最大靜夾持力 Max. Gripping Force kgf (KN)		最大設定油壓壓力 Max. Pressure Setting kgf/cm <sup>2</sup> (Mpa)		氣壓夾持力 Gripping Force At Air Pressure 7kgf/cm <sup>2</sup> (0.7Mpa) kgf (KN)		夾持範圍 Gripping Range
PLVE-06	2950	(29)	16	(1.57)	1270	(12.5)	ø35~ø160
PLVE-08	4890	(48)	15	(1.47)	2240	(22)	ø40~ø210
PLVE-10	4990	(49)	16	(1.57)	2140	(21)	ø40~ø210

# TB AIR FEED TUBE

## 氣壓迴轉器

新產品  
**NEW**



### 尺寸圖 > Dimensions

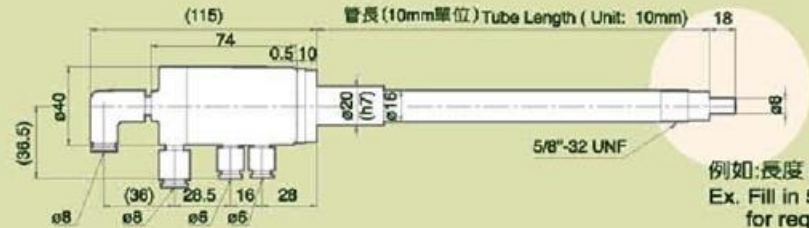

例如:長度 500mm 時填記 50。  
Ex. Fill in 50  
for required length of 500mm.

### 規格表 > Specifications

單位/UNIT:mm

型式/規格 MODEL / SPEC.	最高迴轉速 Max.Speed	推薦潤滑油 Recommended Lubricant
TB-XX-18	8000min <sup>-1</sup>	VG6同等級油 VG6 or Equal

# TBC AIR FEED TUBE ( FOR GRINDING MACHINES )

## 氣壓迴轉器 (注水型)

新產品  
**NEW**



### 尺寸圖 > Dimensions

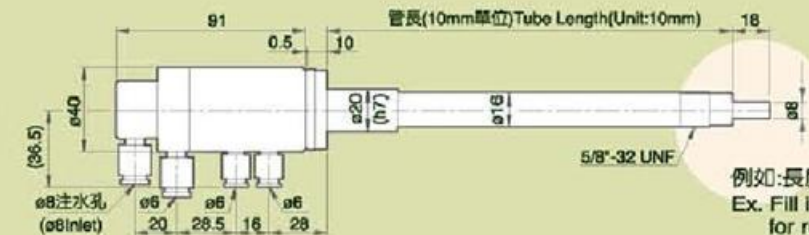

例如:長度 500mm 時填記 50。  
Ex. Fill in 50  
for required length of 500mm.

### 規格表 > Specifications

單位/UNIT:mm

型式/規格 MODEL / SPEC.	最高迴轉速 Max.Speed	推薦潤滑油 Recommended Lubricant
TBC-XX-18	8000min <sup>-1</sup>	VG6同等級油 VG6 or Equal

# MTB AIR FEED TUBE

泉發車刀礦油公司 網頁專用

## 氣壓迴轉器

新產品  
**NEW**

尺寸圖 > Dimensions

單位/UNIT:mm

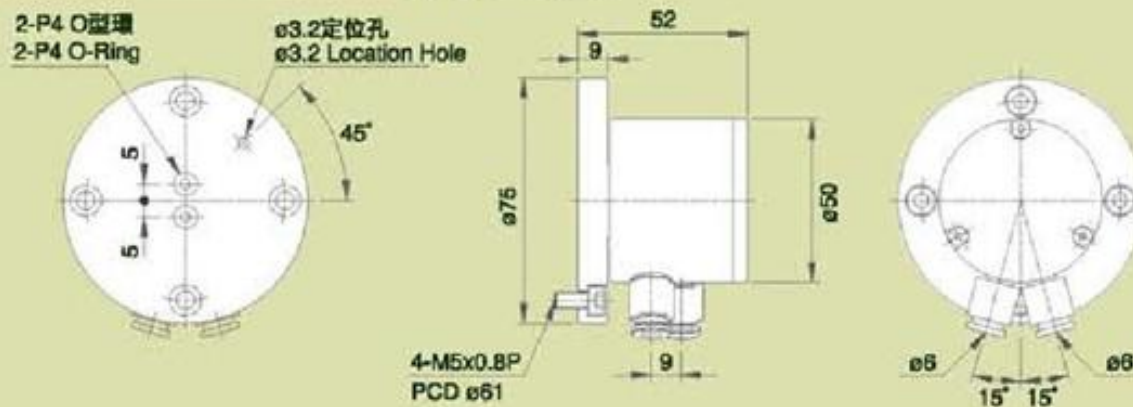

# ADP MOUNTING PLATES

## 連結盤

尺寸圖 > Dimensions

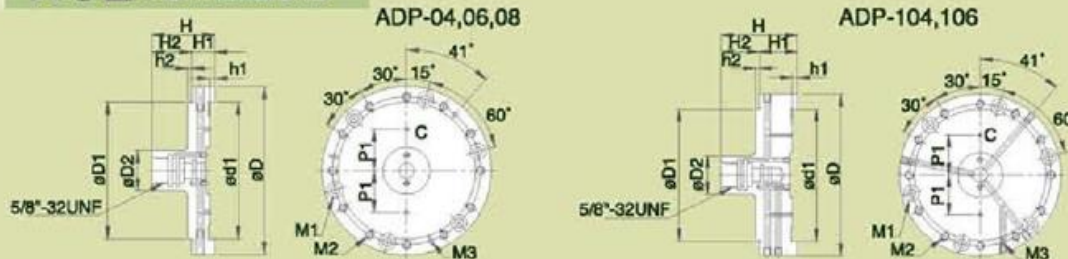

規格表 > Specifications

單位/UNIT:mm

型式/規格 MODEL / SPEC.	D	D1 (h7)	D2	d1 (h7)	P1	H	H1	H2	h1	h2	M1	M2	M3
ADP-04	101.6	82.55	24	82.55	25	38	14	24	3.2	2.5	6-M5x0.8P (PCD $\phi$ 88.9)	12-M5x0.8P (PCD $\phi$ 88.9)	3- $\phi$ 3 (PCD $\phi$ 88.9)
ADP-06	152.4	124.97	24	124.97	34.5	38	14	24	3.2	2.5	6-M6x1P (PCD $\phi$ 135.89)	12-M6x1P (PCD $\phi$ 135.89)	3- $\phi$ 3 (PCD $\phi$ 135.89)
ADP-08	203.2	167.64	30	167.64	50	54	25	29	7.0	5.0	6-M10x1.5P (PCD $\phi$ 182.88)	6-M10x1.5P (PCD $\phi$ 182.88)	3- $\phi$ 4 (PCD $\phi$ 182.88)
ADP-104	101.6	82.55	24	82.55	25	48	24	24	3.2	2.5	6-M5x0.8P (PCD $\phi$ 88.9)	12-M5x0.8P (PCD $\phi$ 88.9)	3- $\phi$ 3 (PCD $\phi$ 88.9)
ADP-106	152.4	124.97	24	124.97	34.5	48	24	24	3.2	2.5	6-M6x1P (PCD $\phi$ 135.89)	12-M6x1P (PCD $\phi$ 135.89)	3- $\phi$ 3 (PCD $\phi$ 135.89)

# FR FORMING RINGS ( FOR SOFT JAWS OF SUPER PRECISION AIR CHUCKS )

## 超精密生爪成型盤

尺寸圖 > Dimensions

新產品  
**NEW**

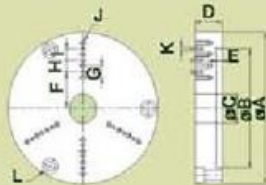

規格表 > Specifications

單位/UNIT:mm

型式/規格 MODEL / SPEC.	A	B	C	D	E	F	G	H	I	J	K	L	淨重 Weight (Kg)
FR-04	112	80	22	30	6	21	12.7	12.7	12.7	6-M5x0.8P	9- $\phi$ 3.175	3-M8x1.25P	1.9
FR-06	167	130	30	30	6	40	12.7	12.7	12.7	12-M5x0.8P	9- $\phi$ 3.175	3-M10x1.5P	4.3
FR-08	203	160	54	35	6	66	25.4	25.4	--	6-M10x1.5P	6- $\phi$ 6.35	3-M10x1.5P	7.2

# ADP MOUNTING PLATES

## 連結盤

尺寸圖 > Dimensions

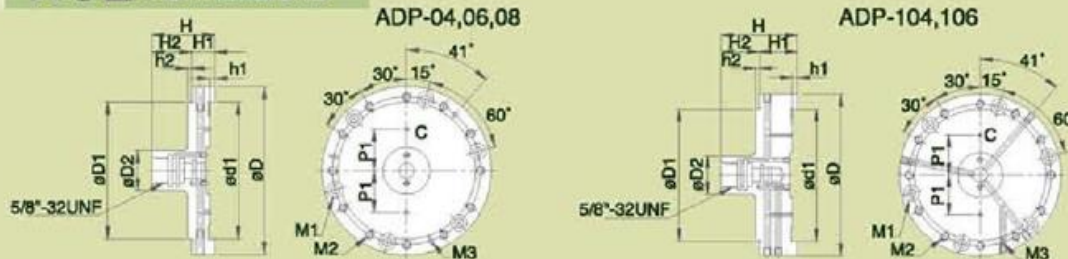

規格表 > Specifications

單位/UNIT:mm

型式/規格 MODEL / SPEC.	D	D1 (h7)	D2	d1 (h7)	P1	H	H1	H2	h1	h2	M1	M2	M3
ADP-04	101.6	82.55	24	82.55	25	38	14	24	3.2	2.5	6-M5x0.8P (PCD ø88.9)	12-M5x0.8P (PCD ø88.9)	3-ø3 (PCD ø88.9)
ADP-06	152.4	124.97	24	124.97	34.5	38	14	24	3.2	2.5	6-M6x1P (PCD ø135.89)	12-M6x1P (PCD ø135.89)	3-ø3 (PCD ø135.89)
ADP-08	203.2	167.64	30	167.64	50	54	25	29	7.0	5.0	6-M10x1.5P (PCD ø182.88)	6-M10x1.5P (PCD ø182.88)	3-ø4 (PCD ø182.88)
ADP-104	101.6	82.55	24	82.55	25	48	24	24	3.2	2.5	6-M5x0.8P (PCD ø88.9)	12-M5x0.8P (PCD ø88.9)	3-ø3 (PCD ø88.9)
ADP-106	152.4	124.97	24	124.97	34.5	48	24	24	3.2	2.5	6-M6x1P (PCD ø135.89)	12-M6x1P (PCD ø135.89)	3-ø3 (PCD ø135.89)

# FR FORMING RINGS ( FOR SOFT JAWS OF SUPER PRECISION AIR CHUCKS )

## 超精密生爪成型盤

尺寸圖 > Dimensions

新產品  
**NEW**

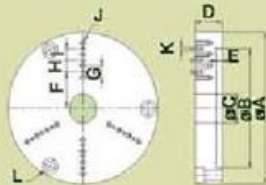

規格表 > Specifications

單位/UNIT:mm

型式/規格 MODEL/ SPEC.	A	B	C	D	E	F	G	H	I	J	K	L	淨重 Weight (Kg)
FR-04	112	80	22	30	6	21	12.7	12.7	12.7	6-M5x0.8P	9-ø3.175	3-M8x1.25P	1.9
FR-06	167	130	30	30	6	40	12.7	12.7	12.7	12-M5x0.8P	9-ø3.175	3-M10x1.5P	4.3
FR-08	203	160	54	35	6	66	25.4	25.4	-	6-M10x1.5P	6-ø6.35	3-M10x1.5P	7.2



# SOFT JAWS FOR SUPER PRECISION CHUCKS

## 超精密夾頭生爪

新產品  
**NEW**



### 尺寸圖 > Dimensions

單位/UNIT:mm

J-04

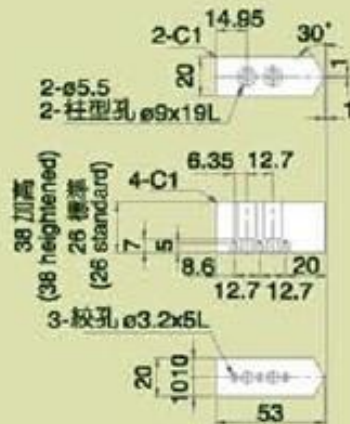

J-06

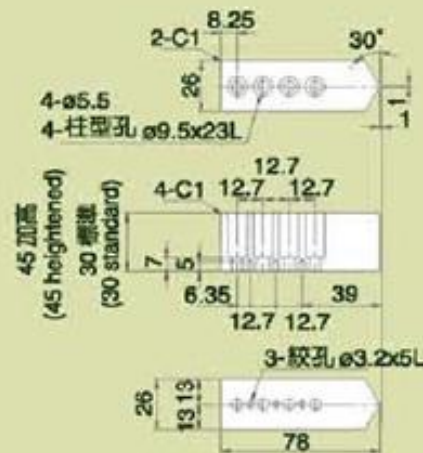

J-08

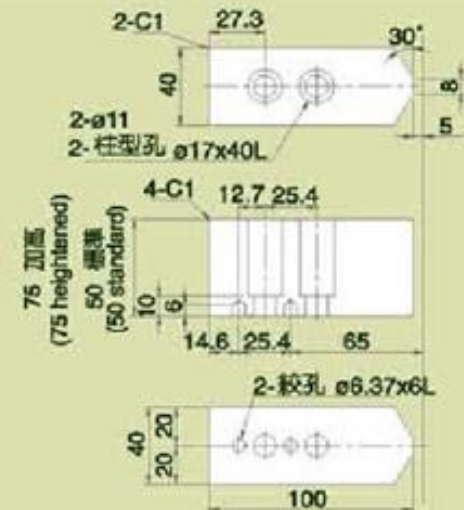

# MR-S

## 3-JAW AIR CHUCK BUILT-IN 2 CYLINDERS

### 雙氣缸三爪氣壓夾頭

新產品  
**NEW**

專利產品  
Patent Protected



#### 尺寸圖 > Dimensions

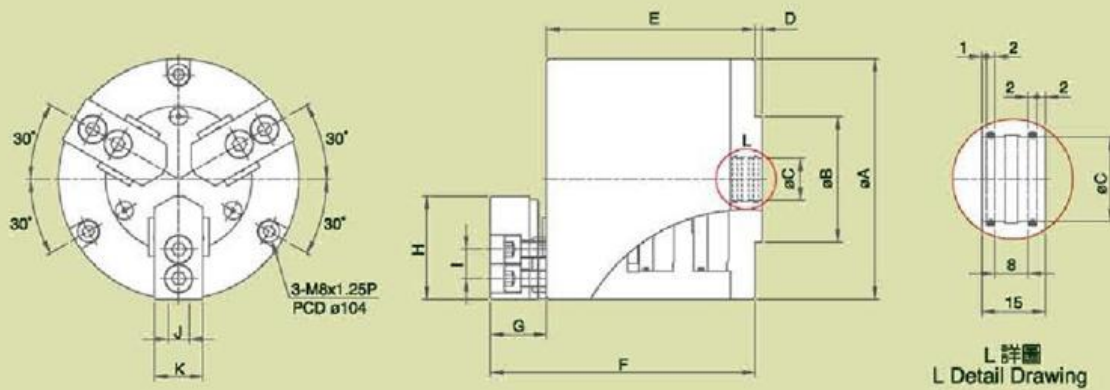

#### 分度盤使用範例 > Operation Example for rotary table

#### CNC車床使用範例 > Operation Example for CNC Lathe



#### 規格表 > Specifications

單位/UNIT:mm

型式/規格 MODEL / SPEC.	A	B	C	D	E	F	G	H	I	J	K	活塞面積 Piston Area (cm <sup>2</sup> )	
MR-04S	117	60	20	3.5	99.7	126.4	26.7	49.5	14	10	23	114	
型式/規格 MODEL / SPEC.	柱塞行程 Plunger Stroke (mm)		爪行程直徑 Jaw Stroke (Diameter) mm		空壓夾持力 Gripping Force At Air Pressure 7 kg/cm <sup>2</sup> (0.7Mpa) kgf			最高迴轉速 Max.Speed r.p.m (min <sup>-1</sup> )		夾持範圍 Gripping Range		淨重 Weight (kg)	
MR-04S	9		3.8		2200			(21.6)		4500		ø10~ø117	7.2